

NDA-U-CBBS SMB, Dinion 3100i IR



- ▶ Modular design for fast and easy installation
- ▶ Weather resistant finish to maintain cosmetic appearance
- ▶ Vandal resistant design
- ▶ Impact, shock and vibration resistant

The modular camera mounts & accessories are a family of mounts, mounting adapters, pendant interface plates and surveillance cabinets which can be used with a wide range of Bosch cameras. The accessories are easy to install and can be combined to simplify installation in multiple locations while retaining the same look and feel.

Functions

This easy-to-install and sturdy mount box is specifically designed for mounting DINION 3100i IR and FLEXIDOME micro 3100i outdoor cameras to a flat surface.

This accessory comes ready for installation to a wall or ceiling. To adapt it to be mounted to a pole or corner, the following accessory must be used with:

- NDA-U-PMAS Pole mount adapter small

Regulatory information

Environmental

Salt mist	IEC60068-2-52
Vibration	IEC60068-2-6
Shock	IEC60068-2-27
Impact	IK10

Installation/configuration notes

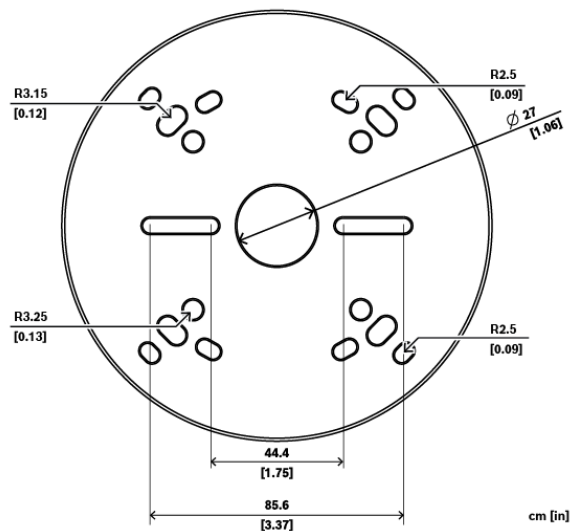

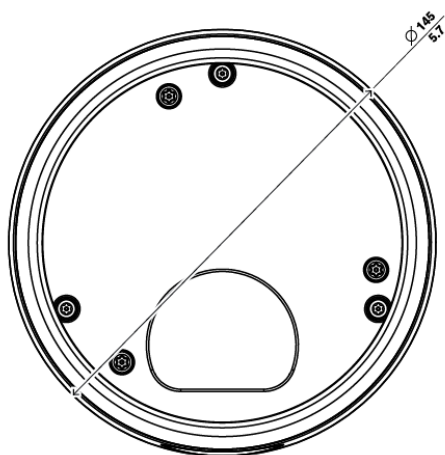
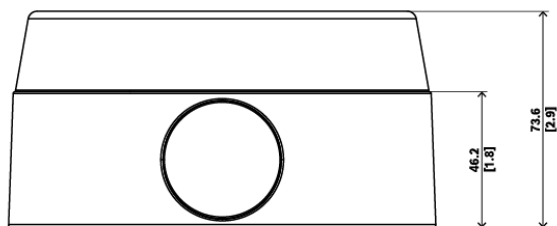

cm [in]

Dimensions in mm (inch)

Parts included

Quantity	Component
1	NDA-U-CBBS Surface mount box
3	M4x12 screws
1	Quick installation guide

Technical specifications

Mechanical

Mounting type	Surface-mounted
Color	White
Color (RAL)	RAL 9003 Signal white
Material	Conduit back box: Aluminum; Cover ring: Polycarbonate
Dimensions (Ø x H) (cm)	14.5 cm x 7.4 cm

Represented by:

Europe, Middle East, Africa:
Bosch Security Systems B.V.
P.O. Box 80002
5600 JB Eindhoven, The Netherlands
www.boschsecurity.com/xc/en/contact/
www.boschsecurity.com

Germany:
Bosch Sicherheitssysteme GmbH
Robert-Bosch-Platz 1
D-70839 Gerlingen
www.boschsecurity.com

North America:
Bosch Security Systems, LLC
130 Perinton Parkway
Fairport, New York, 14450, USA
www.boschsecurity.com

Asia-Pacific:
Robert Bosch (SEA) Pte Ltd, Security Systems
11 Bishan Street 21
Singapore 573943
www.boschsecurity.com/xc/en/contact/
www.boschsecurity.com

Dimensions (Ø x H) (in)	5.7 in x 2.9 in
Weight (g)	787 g
Weight (lb)	1.74 lb

Ordering information

NDA-U-CBBS SMB, Dinion 3100i IR

Conduit back box for DINION 3100i IR and FLEXIDOME micro 3100i outdoor

Order number **NDA-U-CBBS**